

**PLUS 600 WIRE
CONDUIT+GAS**







CE EN60974-7

CODE	↔	☐
------	---	---

MB2300	3 m	10'	
MB2301	4 m	12'	
MB2302	5 m	16.4'	

TECHNICAL DATA		
----------------	--	--

		
	1,45 kg	3,20 lb
V PEAK	113	
	1,0 ÷ 2,4 mm	.040" ÷ 3/32"
X 100%	600A CO2 - 550A Mix	
	2÷4 bar	
	1,6 l/min	

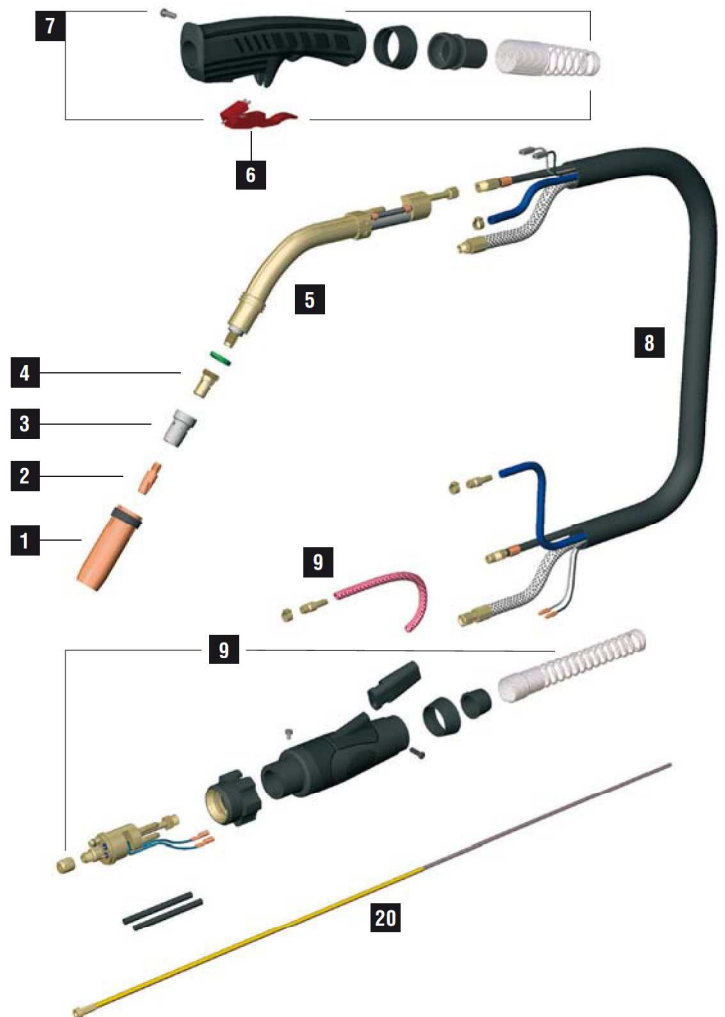
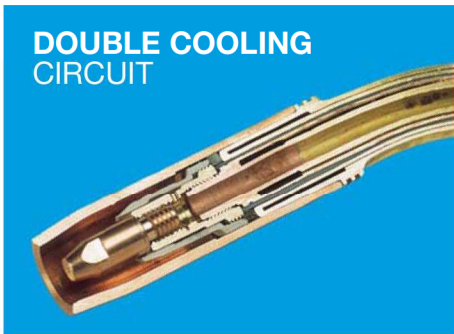
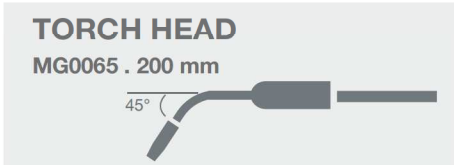

	CODE			Ø			REF		
1	MC0268		2,5 mm	16 mm	5/8"	76 mm	145.0085	10	
1	MC0276		light 2 mm	16 mm	5/8"	76 mm	145.0085	10	
1	MC0290		2,5 mm	14 mm		76 mm	145.0132	10	
1	MC0291		2,5 mm	20 mm		76 mm	145.0051	10	
1	MC0292		2,5 mm	15 mm		76 mm	-	10	
1	MC0293		2,5 mm	20 mm		82 mm	145.0179	10	
1	MC0340		heavy duty 3 mm	16 mm	5/8"	76 mm	Heavy duty	10	
1	MC0568		quick release 2,5 mm	16 mm	5/8"	76 mm	-	10	
1	MC0576		quick release - light 2 mm	16 mm	5/8"	76 mm	-	10	
2	MD0005-80		M8 - CuCrZr	1,0 mm	.040"	30 mm	140.0316	20	
2	MD0005-82		M8 - CuCrZr	1,2 mm	.045"	30 mm	140.0445	20	
2	MD0005-84		M8 - CuCrZr	1,4 mm	.052"	30 mm	-	20	
2	MD0005-86		M8 - CuCrZr	1,6 mm	1/16"	30 mm	140.0590	20	
3	ME0076		M8 - brass			25 mm	-	10	
3	ME0083		M8 - brass			29 mm	-	10	
3	ME0390		M8 - copper			25 mm	-	10	
4	ME0074		plastic			28 mm	-	10	
4	ME0079		plastic			29 mm	300029	10	
4	ME0479		plastic High Tec			28 mm	-	10	
4	ME0579		ceramic	16 mm	5/8"	28 mm	-	10	
20	GM0540		yellow steel liner	1,2 ÷ 1,6 mm	.045" ÷ 1/16"	3 m	10'	124.0041	1
20	GM0541		yellow steel liner	1,2 ÷ 1,6 mm	.045" ÷ 1/16"	4 m	12'	124.0042	1
20	GM0542		yellow steel liner	1,2 ÷ 1,6 mm	.045" ÷ 1/16"	5 m	16.4'	124.0044	1

CODE			CODE	CABLE		CODE	↔	CODE	↔		
5	FB1327		10			8a	BX0156	3 m / 10'	8f	MQ0205	3 m / 10'
5	MG0065		1			8a	BX0157	4 m / 12'	8f	MQ0206	4 m / 12'
6	BX0024		10			8a	BX0158	5 m / 16.4'	8f	MQ0207	5 m / 16.4'
7	MT0104		1			8d	QB0076	3 m / 10'	8g	QB0090	3 m / 10'
9	AR0052		1			8d	QB0077	4 m / 12'	8g	QB0091	4 m / 12'
9	BW0020					8d	QB0078	5 m / 16.4'	8g	QB0092	5 m / 16.4'
9	FA0026		10			8e	QA0019	3 m / 10'			
9	MT0101		1			8e	QA0020	4 m / 12'			
						8e	QA0021	5 m / 16.4'			

STANDARD

FOR ALL CONSUMABLES SEE PAGE 294